

PLANNING SNAPSHOT MEDIANS FOR 2015

96%
OF APPLICATIONS
are processed within
legislated timeframes

fig. PLNG450 (CUSTOMER SERVICE)

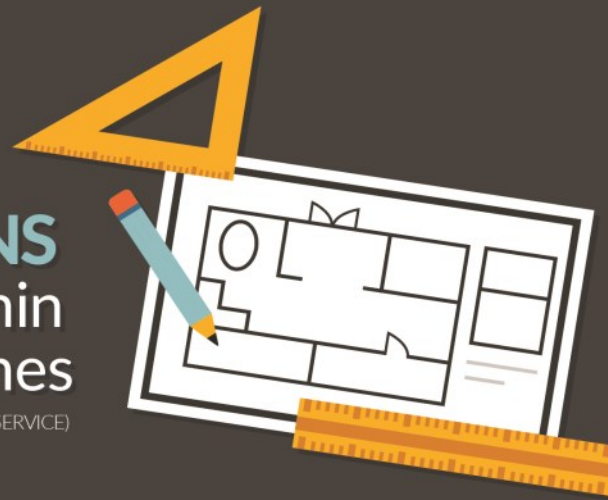

**TOTAL COST
OF PLANNING**

SINGLE TIER

\$22.44/per resident

UPPER TIER

\$8.47/per resident

fig. PLNG250T (SERVICE LEVEL)

KEEP IN MIND:

Influencing Factors

Influencing factors can create variances in comparison data from year-to-year and from municipality-to-municipality.



Application Variables

Type, mix and complexity of applications received



Complexity

Scope and magnitude of applications received



Government Structure

Single-tier vs. upper-tier municipalities



Legislation

Differences or variations in policy may impact applications



Organizational Form

Differing models may affect application review process



Timing

Process times vary per type of application and approvals

For a full description of influencing factors, please go to: www.mbncanada.ca

Fig. 24.1 Total Cost for Planning per Capita

The amount spent on planning-related activities and application processing can vary significantly from municipality to municipality based on the types of applications. This reflects the different organizational structures and priorities established by local Councils.

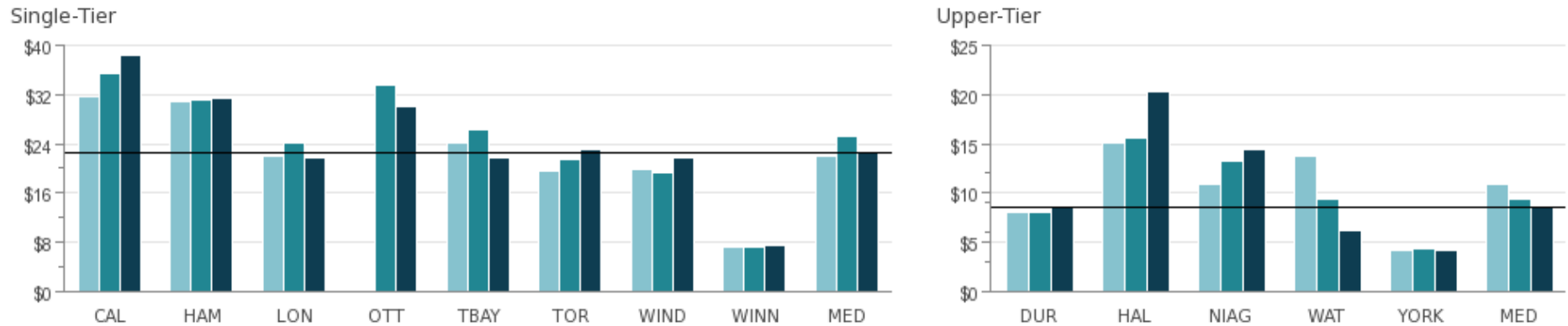

2013	\$31.52	\$30.87	\$21.86	N/A	\$24.07	\$19.49	\$19.98	\$7.15	\$21.86	\$8.09	\$15.05	\$10.90	\$13.76	\$4.26	\$10.90
2014	\$35.38	\$31.07	\$24.25	\$33.63	\$26.30	\$21.35	\$19.32	\$7.30	\$25.28	\$8.06	\$15.55	\$13.19	\$9.32	\$4.28	\$9.32
2015	\$38.31	\$31.38	\$21.65	\$29.92	\$21.81	\$23.06	\$21.71	\$7.42	\$22.44	\$8.47	\$20.25	\$14.41	\$6.19	\$4.17	\$8.47

Source: PLNG250T (Service Level)

Fig. 24.2 Percent of Development Applications Meeting Planning Act Timeframes (Ontario - Single-Tier only)

This measure shows single-tier municipalities only and the percentage of development applications processed that meet the Ontario Planning Act timeframe. Factors such as the volume and complexity of applications, revisions and additional information and/or study requirements during consideration of applications received may affect the results.

	HAM	LON	OTT	TBAY	WIND	MED
2015	97%	94%	94%	99%	96%	96%

Source: PLNG450 (Customer Service)

Comment:

Toronto does not track this data.

Ontario Planning Act timelines are not applicable to out-of-province members.

